



# 6314 NR Deep groove ball bearings

- SKF Explorer

## Deep groove ball bearings

### Bearing data

[Tolerances](#),

Normal (metric), P6, P5, Normal (inch),

[Radial internal clearance](#),

Matched bearing pairs, Stainless steel  
d < 10 mm, Other bearings

### Bearing interfaces

[Seat tolerances for standard conditions](#),

[Tolerances and resultant fits](#)

## Technical specification

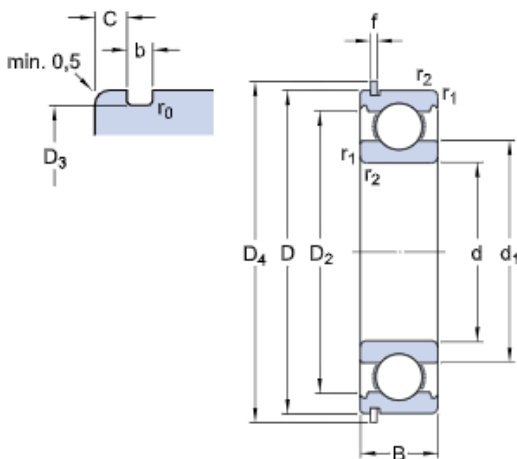

## DIMENSIONS

d	70 mm	Bore diameter
D	150 mm	Outside diameter
B	35 mm	Width
d <sub>1</sub>	≈ 94.95 mm	Shoulder diameter
D <sub>2</sub>	≈ 129.9 mm	Recess diameter
D <sub>3</sub>	145.25 mm	Diameter of snap ring groove
D <sub>4</sub>	159.7 mm	Outside diameter of snap ring
b	3.1 mm	Width of snap ring groove
C	4.9 mm	Distance outer ring from side face to snap ring groove
f	2.82 mm	Width of snap ring
r <sub>0</sub>	max. 0.6 mm	Bottom radius of snap ring groove
r <sub>1,2</sub>	min. 2.1 mm	Chamfer dimension

## ABUTMENT DIMENSIONS

d <sub>a</sub>	min. 82 mm	Diameter of shaft abutment
D <sub>a</sub>	max. 138 mm	Diameter of housing abutment
D <sub>b</sub>	min. 162 mm	Diameter of snap ring recess in the housing

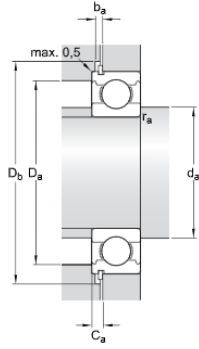

$b_a$	min. 3.5 mm	Width of snap ring recess in the housing
$C_a$	max. 7.72 mm	Distance from outer ring side face to snap ring back face
$r_a$	max. 2 mm	Radius of shaft or housing fillet

CALCULATION DATA

C	111 kN	Basic dynamic load rating
$C_0$	68 kN	Basic static load rating
$P_u$	2.75 kN	Fatigue load limit
	9 500 r/min	Reference speed
	6 300 r/min	Limiting speed
$k_r$	0.03	Minimum load factor
$f_0$	13.2	Calculation factor

MASS

	2.6 kg	Mass bearing
--	--------	--------------

INCLUDED PRODUCTS

SP 150	Snap ring
--------	-----------

TOLERANCE CLASS

P6	Dimensional tolerances
Normal	Radial run-out